

DO NOT ENLARGE OR SHRINK TO FIT PAGE - A3 PLANS TO BE PRINTED 'AS DOCUMENT'

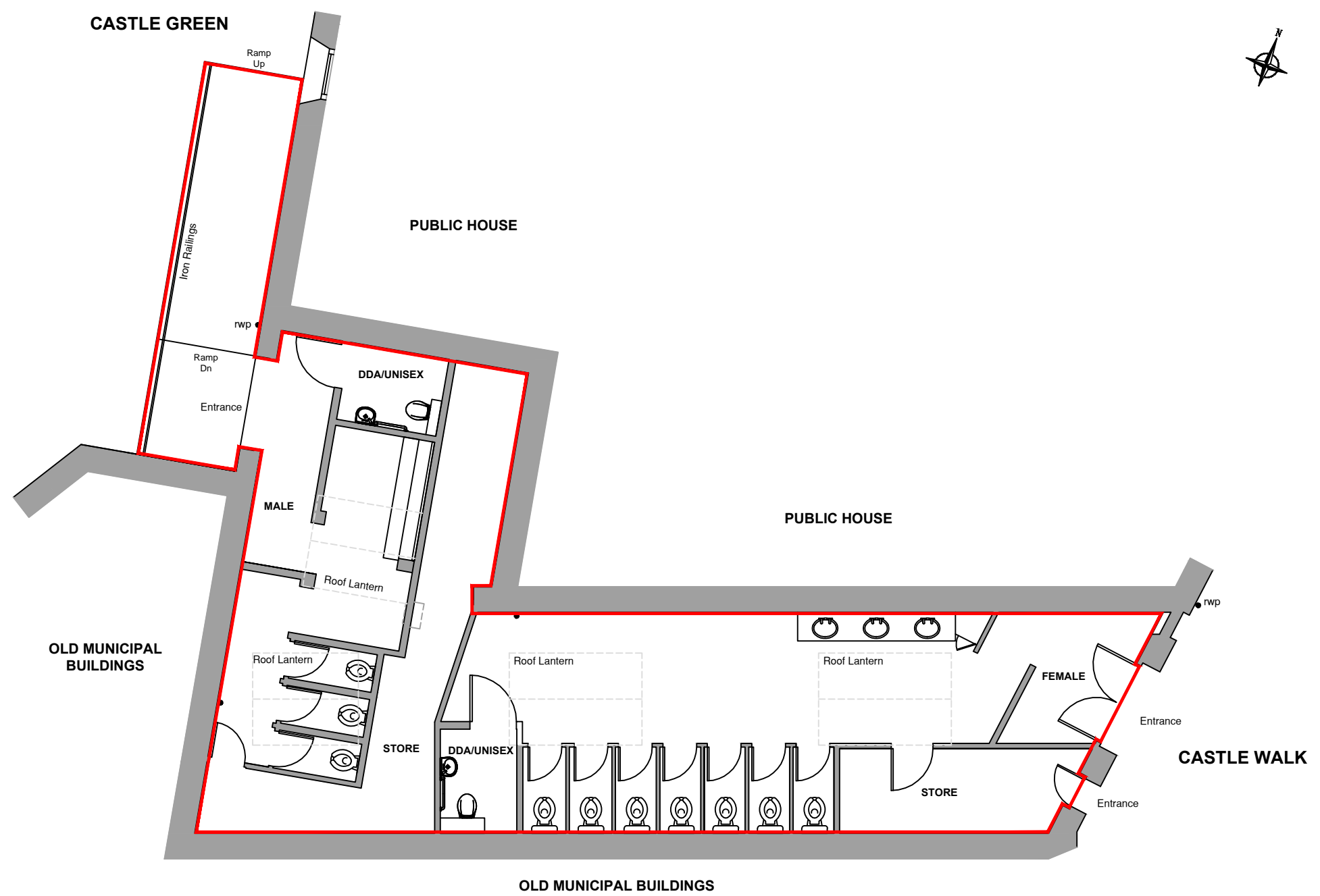

**GROUND FLOOR PLAN**  
SCALE 1:100

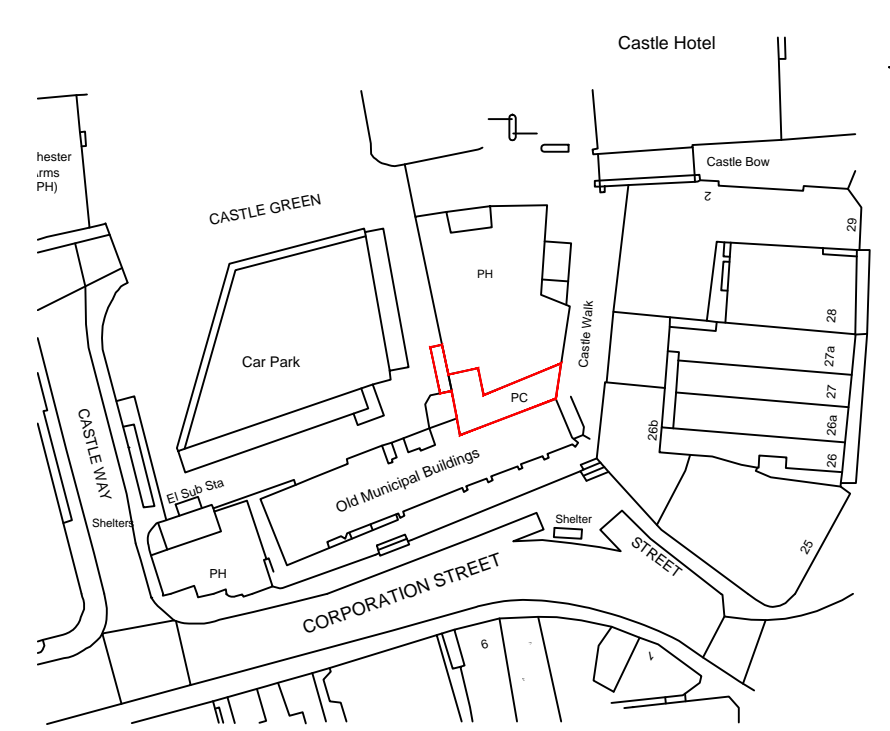

**LOCATION PLAN**  
SCALE 1:1250

© Crown Copyright 2022  
Reproduction in whole or in part is prohibited  
without the prior permission of Ordnance Survey.  
Ordnance Survey Licence No. 011575047

Propertyplans (Southwest) Ltd © Copyright Protected 2022

client SOMERSET WEST AND TAUNTON	address PUBLIC CONVENIENCES AT CASTLE GREEN TAUNTON TA1 4AQ	dwg <b>LEASE PLAN</b>	date 08.12.2022	scale	sheet A3	<b>Propertyplans</b> (Southwest) Ltd 11 west villas cotford st luke taunton ta4 1df tel. 01823 215 005 mob. 07866 422 575 email. info@property-plans.net web. www.property-plans.net
			dwg.no. 2022067 CG1	revision		