

DO NOT ENLARGE OR SHRINK TO FIT PAGE - A3 PLANS TO BE PRINTED AS DOCUMENT

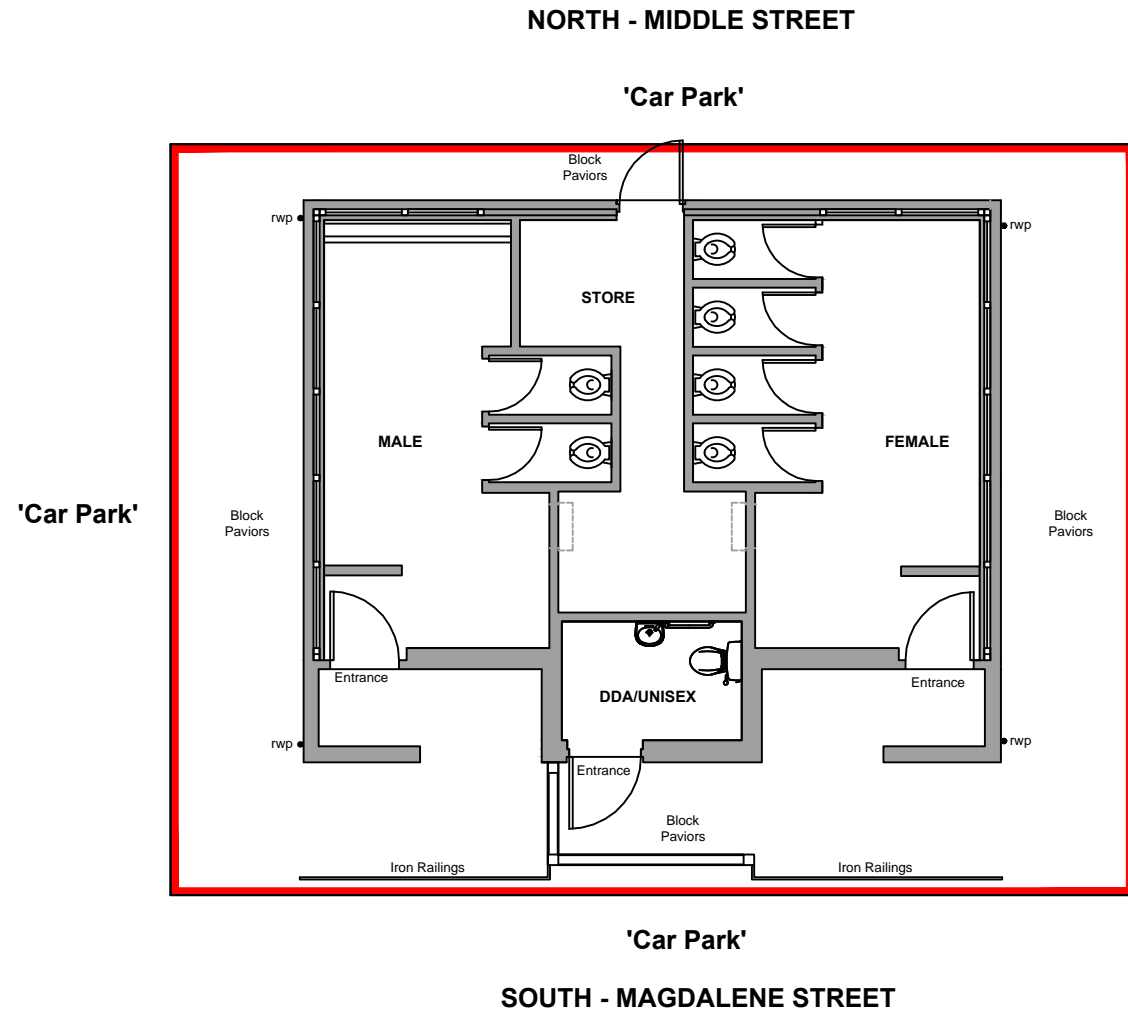

GROUND FLOOR PLAN
SCALE 1:100



LOCATION PLAN
SCALE 1:1250

© Crown Copyright 2022
Reproduction in whole or in part is prohibited
without the prior permission of Ordnance Survey.
Ordnance Survey Licence No. 011575043

Propertyplans (Southwest) Ltd © Copyright Protected 2022

client SOMERSET WEST AND TAUNTON	address PUBLIC CONVENIENCES AT CANON STREET CAR PARK TAUNTON TA1 1RT	dwg LEASE PLAN	date 08.12.2022	scale	sheet A3	Propertyplans (Southwest) Ltd 11 west villas cotford st luke taunton ta4 1df tel. 01823 215 005 mob. 07866 422 575 email. info@property-plans.net web. www.property-plans.net
			dwg.no. 2022067 CS1	revision		